

Sustainable Agriculture Skill Panel Forum

Hilton Hawaiian Village
Mid-Pacific Conference Center
South Pacific Ballrooms
December 14, 2011
8:30 am to 4:00 pm



GOALS

In order to re-establish agriculture as an essential component for the well-being of our island community, a capable and competent workforce will be required with the ability to fulfill the unique needs of a progressive agricultural industry.

To accomplish this goal, these Agricultural Skill panels will develop statewide strategic action plans to accomplish the following:

- **Educate** government and community leaders about the importance of the agriculture industry;
- **Develop** an action plan to meet the current and future workforce needs of the local agriculture industry; and
- **Offer** solutions and assist with implementation of initiatives that support/grow Hawaii's agriculture industry.

AGENDA

8:30 am - 9:00 am	Registration
9:00 am - 9:15 am	<p>Welcome Address <i>South Pacific Ballroom</i> The Honorable Neil Abercrombie Governor, State of Hawaii</p>
9:15 am - 9:30 am	<p>The Agriculture Development Workforce Imperative <i>South Pacific Ballroom</i> Russell Kokubun, Chairperson Department of Agriculture - State of Hawaii</p>
9:30 am - 9:45 am	<p>Introduction of Skill Panel Method <i>South Pacific Ballroom</i> Dwight Takamine, Director Department of Labor and Industrial Relations - State of Hawaii</p> <p>Overview of the skill panel method: Expectations for the Panels, industry involvement and thoughts, as well as provide the groups general guidance on how the Panel discussion should flow during the day.</p>

9:45 am - 10:00 am	Break				
10:00 am - 12:00 pm	Panel 1 <i>Sea Pearl 3</i> Expanding Regulatory Capacity	Panel 2 <i>Sea Pearl 1 & 2</i> Enhancing and Increasing Opportunities for Farmers and Farm Workers	Panel 3 <i>Natulus 2</i> Full Build-Out of Agriculture Infrastructure	Panel 4 <i>South Pacific 3</i> Growing Diversified Agriculture	Panel 5 <i>Sea Pearl 4 & 5</i> Practical Application of Agricultural Skills
	<p>Panel Co-Chairs convene each Panel, introduce facilitators and explain their role. Members introduce themselves and the perspective they represent (education, employer, etc.).</p> <p>The co-chairs go over pre-meeting materials and get agreement on the purposes of the Panel, define the problem statement(s) that will form 3-4 focus areas, and exchange information requested prior to the meeting.</p> <p>Industry leaders identify the workforce concerns and comment on the connection with education, training and recruitment. They should address why industry is at the table for this discussion. What is keeping them up at night related to the workforce needs in these targeted skill sets?</p> <p>Discuss what each group brings to the table—resources, assets, and requirements. Obtain agreement on desired outcomes for the Panel.</p>				
12:00 pm - 1:15 pm	Lunch				
Lunch to be served in the South Pacific Ballroom.					
Presentations and Discussions of Department of Education Agriculture Programs.					
1:15 pm - 3:00 pm	Panel 1 <i>Sea Pearl 3</i> Expanding Regulatory Capacity	Panel 2 <i>Sea Pearl 1 & 2</i> Enhancing and Increasing Opportunities for Farmers and Farm Workers	Panel 3 <i>Natulus 2</i> Full Build-Out of Agriculture Infrastructure	Panel 4 <i>South Pacific 3</i> Growing Diversified Agriculture	Panel 5 <i>Sea Pearl 4 & 5</i> Practical Application of Agricultural Skills
	<p>Panels will discuss the outcomes and determine the schedule and assignments for each focus area. Issues include clear career pathways for high-need occupations, changing skill requirements, work readiness skills and aptitudes, and bridging skill gaps.</p>				
3:00 pm - 3:50 pm	Final Plenary/Wrap-up Session - South Pacific Ballroom <i>South Pacific Ballroom</i>				
Co-Chairs and Panel Members will conduct Report out and discuss next steps.					
3:50 pm - 4:00 pm	Final announcements/next steps				
4:00 pm	Forum Adjourned				

Lunch to be served as an integral part of this meeting.

HILTON HAWAIIAN VILLAGE MID PACIFIC CONFERENCE CENTER
SOUTH PACIFIC BALLROOMS
(Coral Ballroom area, second floor)

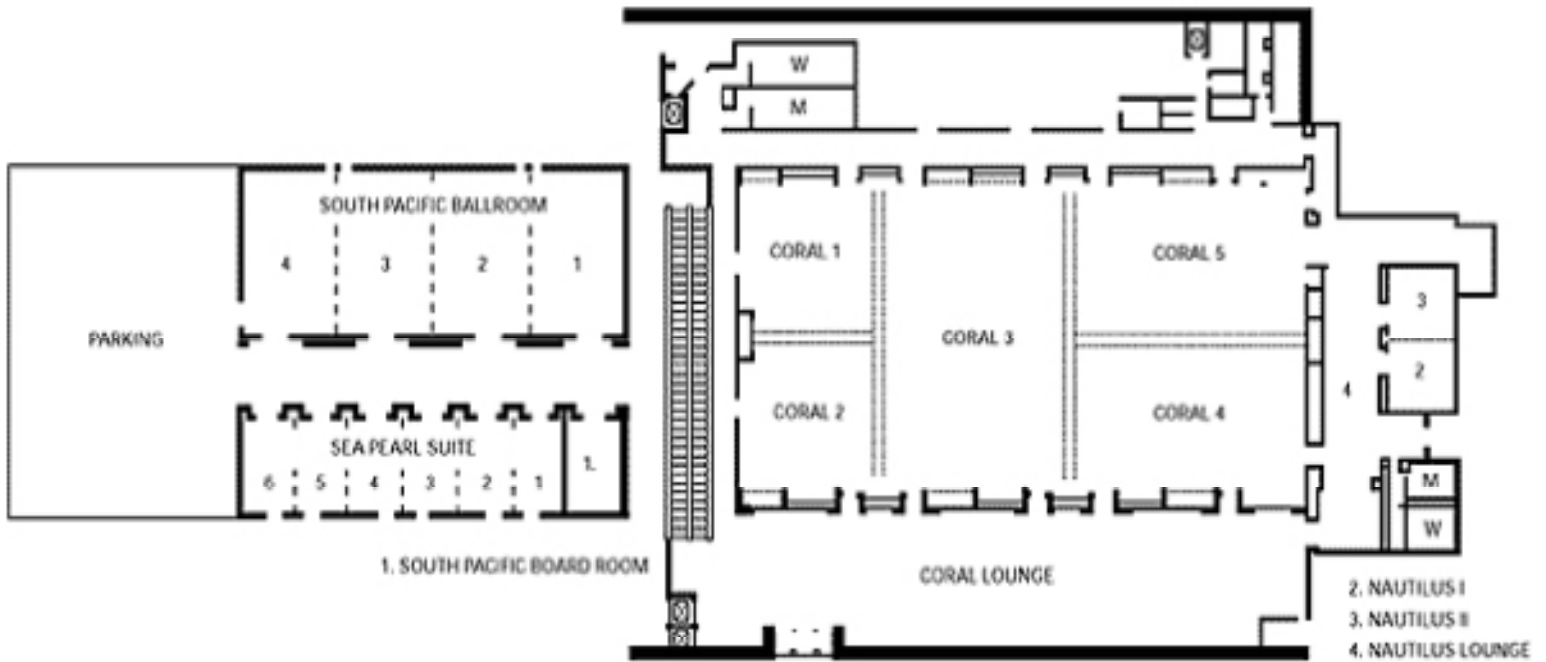

LOCATION OF HILTON HAWAIIAN VILLAGE, WAIKIKI, HONOLULU

